

BR606

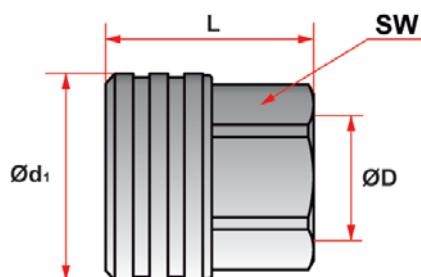

Quick-release coupling
 Racord rapido
 Końcówka szybkozłącza
 Racord rapido
 Racord rapide



D	d1	L	SW	without valve /sin valvula	
				REF.	
G 1"	57	57	46	BR606.25 DG 33	
G 1"1/4	65	62	54	BR606.33 DG 42	
G 2"	89	70	77	BR606.50 DG 60	
G 2"1/2	109	84	90	BR606.63 DG 75	

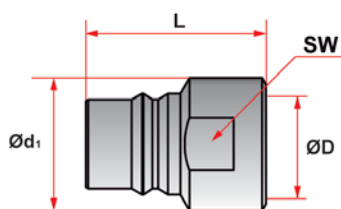

D	d1	L	SW	without valve /sin valvula	
				REF.	
G 1"	45	61	41	BR606.25 DR 33	
G 1"1/4	55	66	50	BR606.33 DR 42	
G 2"	75	78	71	BR606.50 DR 60	
G 2"1/2	90	83	84	BR606.63 DR 75	

BSP Threads - Cylindrical = "G" Conical = "R"

Roscas BSP - Cilindrica = "G" Cónica = "R"

Mat: Brass
 Mat: Latón

Temperature range: -20°C +100°C
 Rango de temperatura: -20°C + 100°C

Working pressure: 10 bar
 Presión de trabajo : 10 bar