

BR1031

Latch locking unit
 Tirante
 Mechanizm dwustopniowego otwarcia
 Trinco
 Loquet

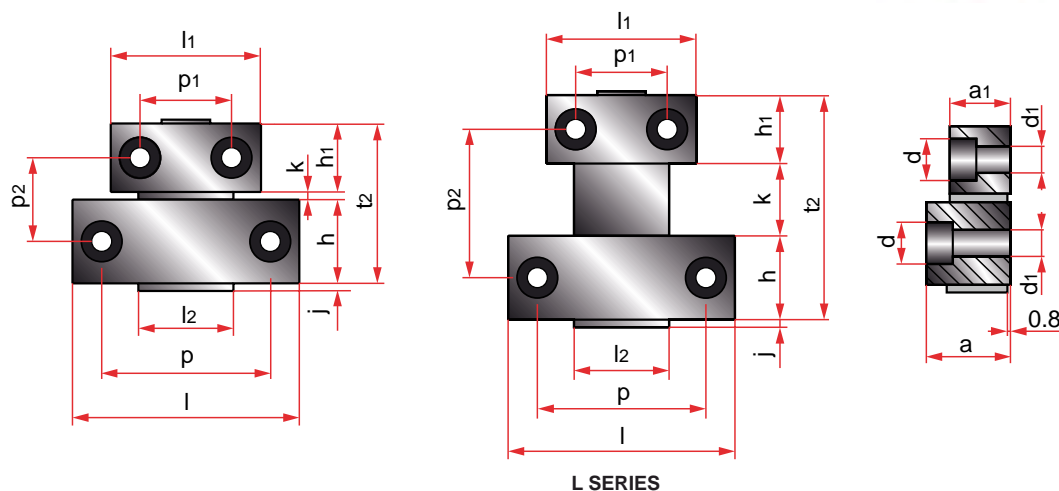

L SERIES

Max. Load (N)	d1	d	a1	a	p2	p1	p	k	j	h1	h	t2	l2	l1	l	REF.				
981	6,5	11	16	24	22	24	36	2	2	18	22	42	25	36	48	BR1031/ 10				
1961						28	40							42	54	BR1031/ 20				
2942	9	14	19	27	26	31	50	3,5	3,5	20	25	48,5	35	46	65	BR1031/ 30				
5884																33	52	50	73	BR1031/ 60
7845																57		34,5	79,5	BR1031/ 60L
																34		11,5	56,5	BR1031/ 80
				65		42,5		87,5	BR1031/ 80L											
9807	11	17	25	34	31	42	76	4	4	24	30	58	48	65	103	BR1031/100				
																62	35	89	BR1031/100L	

